

**AREA SCHEDULE**

Application Site Area: 9941 m<sup>2</sup>  
 SITE AREA: 9517 m<sup>2</sup>

Store Sales Area: 1410.0 m<sup>2</sup>

**WAREHOUSE**

Warehouse: 288.8 m<sup>2</sup>  
 Freezer: 62.6 m<sup>2</sup>  
 Chiller: 43.7 m<sup>2</sup>  
 Storage: 58.6 m<sup>2</sup>

Total Warehouse Area: 453.7 m<sup>2</sup>

**ANCILLARY**

Lobby: 30.2 m<sup>2</sup>  
 Bakery Prep Area: 72.4 m<sup>2</sup>  
 Customer Toilets: 6.2 m<sup>2</sup>  
 Cash Room: 9.4 m<sup>2</sup>  
 Comms Room: 9.4 m<sup>2</sup>  
 Office: 10.0 m<sup>2</sup>  
 Staff WC: 6.0 m<sup>2</sup>  
 Cloakroom: 15.9 m<sup>2</sup>  
 Welfare: 28.0 m<sup>2</sup>  
 Utilities: 16.0 m<sup>2</sup>  
 Corridor: 44.6 m<sup>2</sup>

Total Ancillary Area: 248.1 m<sup>2</sup>

Internal Walls: 63.2 m<sup>2</sup>

TOTAL LIDL G.I.A.: 2175 m<sup>2</sup>

Area under separate occupation

GROUND FLOOR  
 GEA (RETAIL) 2271m<sup>2</sup>

GEA (GF OFFICE) 148m<sup>2</sup>

GEA (GF TOTAL) 2419m<sup>2</sup>

GEA (FF OFFICE) 441m<sup>2</sup>

BUILDING TOTAL GEA 2860m<sup>2</sup>

GIA (RETAIL) 2175m<sup>2</sup>

GIA (OFFICE GF) 131m<sup>2</sup>

GIA (OFFICE FF) 415m<sup>2</sup>

BUILDING TOTAL GIA 2721M<sup>2</sup>

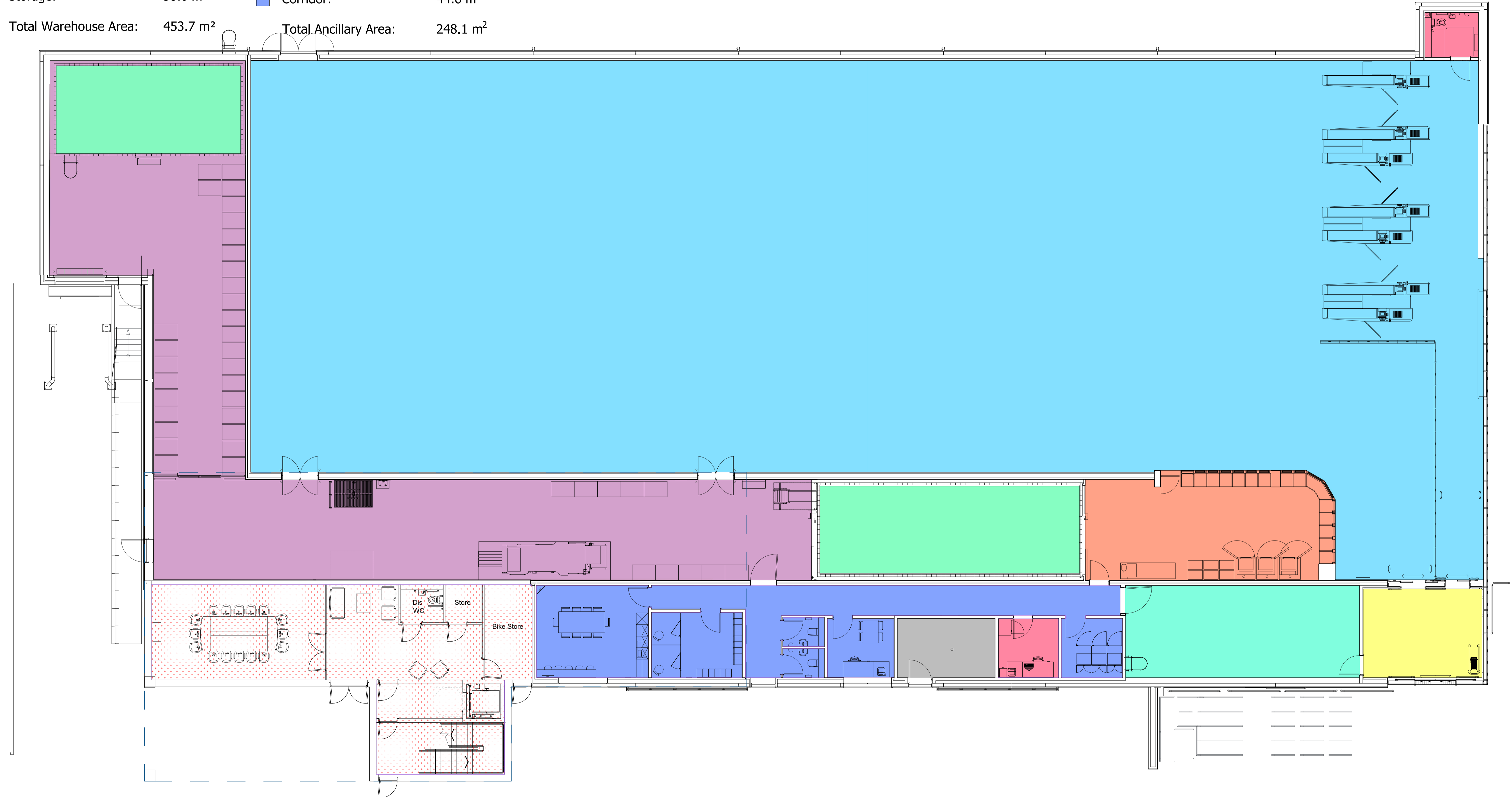

**IMPORTANT INFORMATION**  
 Dimensions to be confirmed on site prior to start of works and ODAS to be informed of discrepancies immediately. No dimensions to be scaled from this drawing.  
 All materials and works are to be carried out in accordance with current British Standards, Planning Approval, current Building Regulations and Codes of Practice.  
 Party Wall Act - Notices under the Party Wall Act are to be served by the property owner or appointed third party by property owner.  
 Health and Safety - CDM 2015 Regulations apply to all construction works to be carried out and apply to designers, contractors and the client. As such all parties have duties under these regulations.

Notes

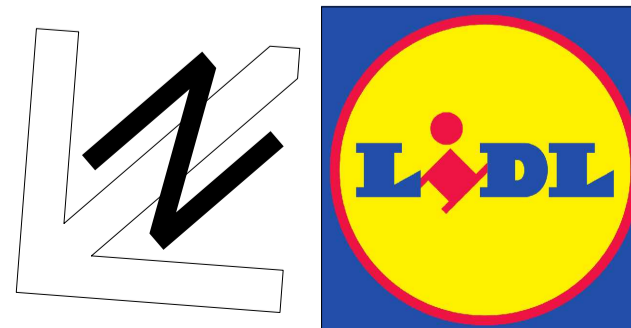

Rev	Date	Description	Revised By	Checked By
B	16.12.19	SCHEDULE UPDATED AS REQUESTED	paah	
A	10.12.19	SCHEDULE UPDATED AS REQUESTED	paah	

Revisions

**Client:**  
 LIDL GREAT BRITAIN LTD  
 1ST FLOOR, 807-829 LONGBRIDGE ROAD, DAGENHAM, ESSEX, RM8 2DB.

**Project Name:**  
 FOOTSCRAY HIGH STREET, SIDCUP, KENT, DA14 5HJ

**Drawing Title:**  
 GROUND FLOOR PLAN

**Drawing Status:** PLANNING

**Project No:** 19208  
**Drawing No:** AD 111\_REV B  
**Drawn By:** PAH  
**Checked By:** LMC  
**Date:** OCT 2019  
**Scale @ A1:** 1:100

**ONE DESIGN ARCHITECTURAL SERVICES**

One Design Architectural Services Ltd  
 Unit 1 Merchants Quay,  
 Phase II, Ashley Lane, Shipley,  
 West Yorkshire, BD17 7DB  
 Tel: 01274 591188  
 www.onedesignarchs.com  
 mail@onedesignarchs.com  
 Registered in England & Wales No: 8355643