

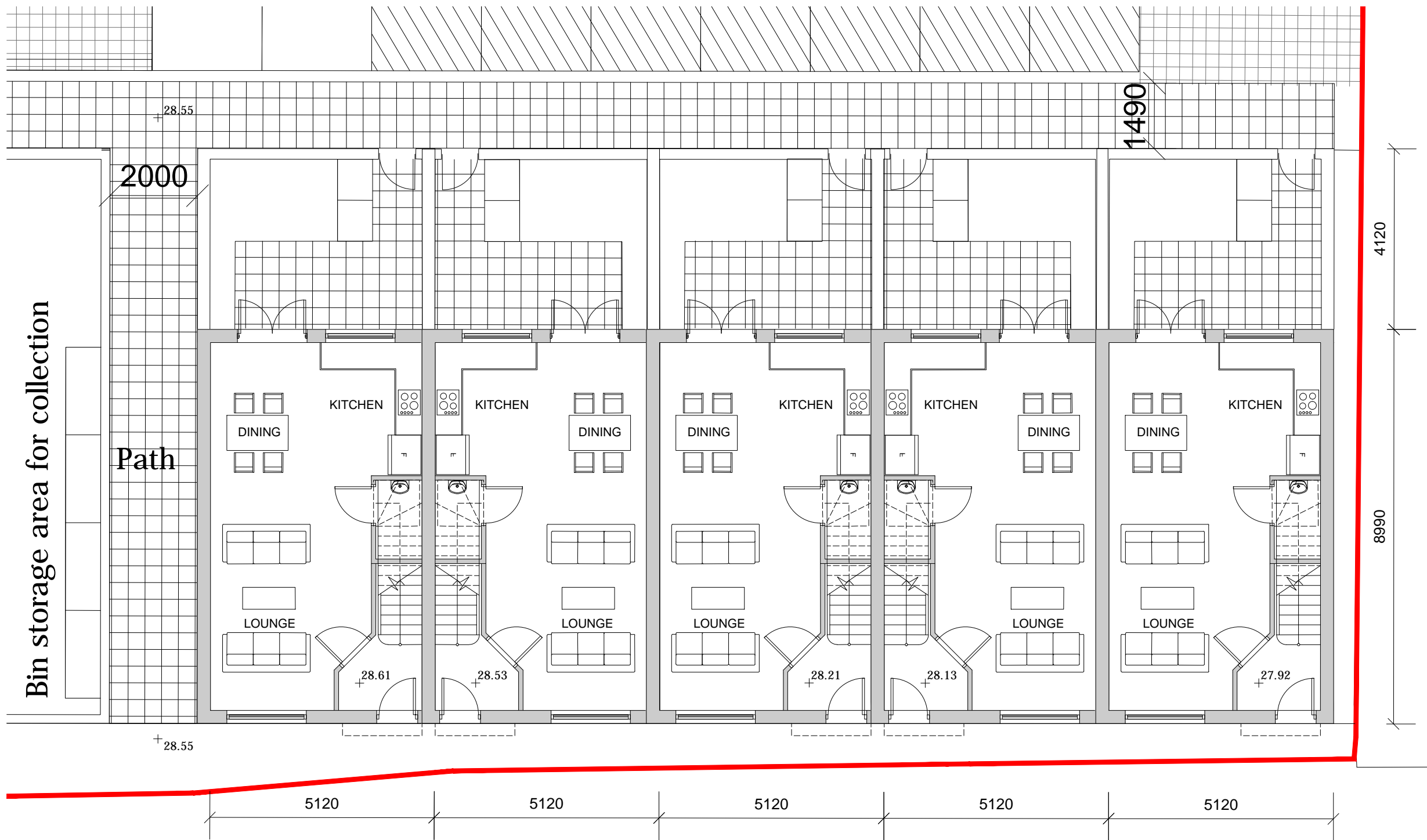

clients logo



Bin storage area for collection

2000

Path

28.55

1490

4120

8990

28.55

5120

5120

5120

5120

5120

28.61

28.53

28.21

28.13

27.92

REV	DATE	DESCRIPTION	BY
2	15.03.17	Amended to client's comments	AW
1	14.03.17	Amended to client's comments	AW

IN CASE OF DOUBT OR DISCREPANCIES PLEASE REFER TO ARCHITECT FOR INSTRUCTIONS.  
DRAWING AND SUITABILITY NUMBERS IN ACCORDANCE WITH BS1192:2007.  
THIS DRAWING SHOULD NOT BE SCALED.  
THIS DRAWING IS COPYRIGHT.

SUITABILITY NUMBER KEY:

<b>WIP</b>	50 - Work in Progress*	<b>DOCUMENTATION - SIGN-OFF</b>
<b>SHARED</b>	S1 - Fit for co-ordination**	A - Fit for construction
	S2 - Fit for information	B - Fit for construction, with comments
	S3 - Fit for internal review and comment	C - Comprehensive revisions needed
	S4 - Fit for construction approval	<b>ARCHIVE</b>
<b>DOCUMENTATION</b>	D1 - Fit for costing	AB - As Built
	D2 - Fit for tender	FC - Final Construction
	D3 - Fit for contractor design	
	D4 - Fit for manufacture/ procurement	

\* For internal pre-issue usage only.  
\*\* For model file usage only.

4th Floor, Greyfriars House  
Greyfriars Road, Cardiff CF10 3AL  
Tel: 029 2055 8900 Fax: 029 2039 9592  
www.boyesrees.co.uk  
Registered office: As above Reg. No. 295 1683 (England & Wales)

PROJECT TITLE:  
Proposed Lidl store at  
Foots Cray High Street  
Sidcup  
Kent  
DA14 5HJ

DRAWING TITLE:  
Townhouse Floor Plans  
Ground Floor Plan

DRAWN BY: AW SCALE: 1:100 @ A3

JOB NO: 5430 DATE: MAR. 17

SUITABILITY: S0 REVISION: 2

PROJECT	ORIGIN	VOLUME	LEVEL	TYPE	DISCIP.	NUMBER
5430	BR	V01	00	DR	A	010103

